

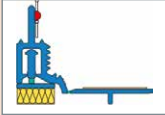

W35 - pro



# APU®

PROFILES FOR COMPOUND HEAT INSULATION SYSTEMS

## Telescopic window reveal bead with mesh

# FLEX-pro

With shadow gap and 12.5 cm mesh

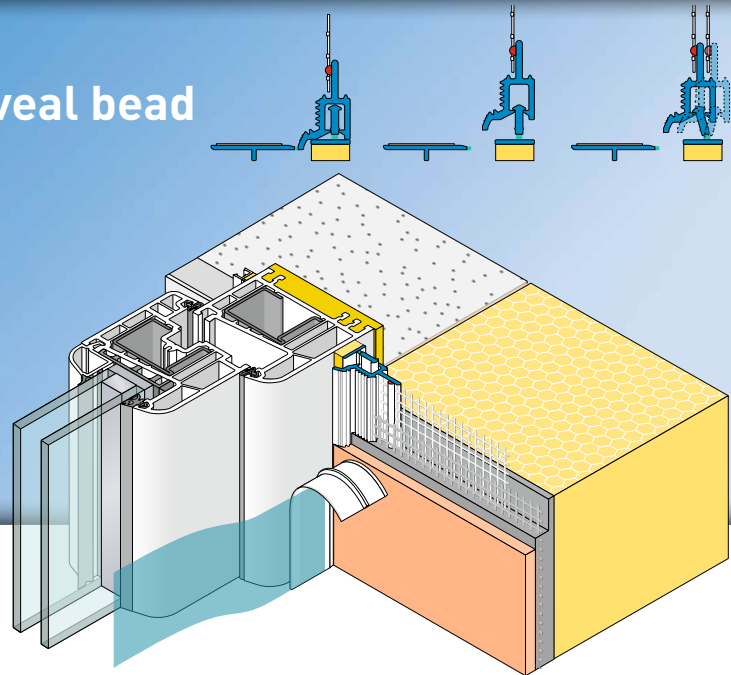

The **APU telescopic window reveal bead with mesh FLEX-plus** is used in compound heat insulation systems as specified in the latest APU selection criteria.

In front of the reveal insulation the profile is stuck flush to the structural element there and after completion of the plastering work forms a clean and reliable termination of the plaster with shadow gap.

The profile comes with a self-adhesive PE foam tape, which ensures a watertight, lasting seal. The integrated telescopic mechanism can absorb



movements in any direction in the area around the joint. The profiles can be joined overlapping where the elements abut. There is a fabric window reveal bead welded onto the profile. Each bar has a fabric overhang on one side of 10cm in the lengthways direction. There is a piece of self-adhesive tape on protective flap in order to secure the third-party protective film. This protects the window during the plastering work. After completion of these tasks, the protective flap is pulled off and what is created is a clean edge to the plaster.

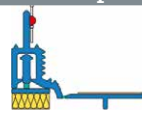

W35 - pro

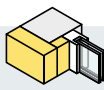
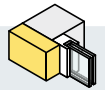

## Area of application

WINDOW POSITION	 WITHIN MASONRY	 FLUSH WITH MASONRY	 IN FRONT OF MASONRY
Sub-surface	With adhesive connection – only for surfaces suitable for being stuck to <b>! Test of adhesion required</b>		
Insulating material thickness	up to 300 mm		
Window size	up to 10 m <sup>2</sup>		
<b>W35 FLEX</b>	■	■	■

Tested according to: ■ VDPM leaflet: Class A with adhesive connection ■ Ö-Norm B 6400-2: Class III

## Fitting

- 1 The sub-surface must be even, dry, free of dust and suitable for the profile to be stuck on permanently. Any residues that would impair adhesion must be removed.
- 2 Perform adhesion test.  
▶ See general tips – APU test of adhesion
- 3 Cut the window reveal bead with mesh to length using suitable trimming shears with supporting surface.
- 4 Pull back the protective flap at top and bottom along the line by about 5 cm (makes removal later easier).
- 5 The vertical profiles get put on first. As you do so, release the profiles' protective flap. Pressing firmly with your thumbs, stick on the profiles aligned with and at an equal distance from the frame profile across the entire length. To do this, pull off the covering paper of the self-adhesive PE foam tape.
- 6 Fit transverse profile into place, flush with the edge.
- 7 Fit insulation as per manufacturer's specifications.
- 8 Prior to the plastering work, pull off the protective flap's covering paper and affix the third-party protective film for protecting the window to the adhesive surface.
- 9 Apply reinforcement base plaster, mesh and final render.  
The top-level mesh must be run up to the skimming edge.
- 10 When the plastering and painting work has been finished, remove the protective film.  
Fold the protective flap forward and backward along its entire length, hold by the pulled back ends and pull it off to the front.

## Important information

- When the work is being done, the surface temperature must be at least +5 degrees and must not exceed +40 degrees.
- After being set in place on the structural element, profiles with a mesh vane must be promptly embedded. Until then they must be protected from the weather, e.g. sun and wind.
- If the necessary profile length is not available, it is possible in the upper third of the structural element to create a butt joint. Connect the profiles, overlapping.
- Where adhesive profiles form a seal through the PE foam tape, we recommend closing the bottom window groove with a suitable sealant.
- To avoid them becoming unduly hot, profiles, especially dark ones, should be shielded from direct sunlight when in storage and prior to being plastered over.
- The processing guidelines of the plaster manufacturer shall be complied with.